



WEBBER - PLAN S1705A2F-0

Total Area: 1705 sq. ft.
Garage Area: 459 sq. ft.
Garage Area: 459 sq. ft.
Garage Size: 2
Stories: 2
Bedrooms: 5
Full Baths: 3
Width: 24'-0"
Depth: 58'-0"
Height: 23'-6"
Foundation: Slab On Grade



WEBBER - PLAN S1705A2F-0

MAIN FLOOR

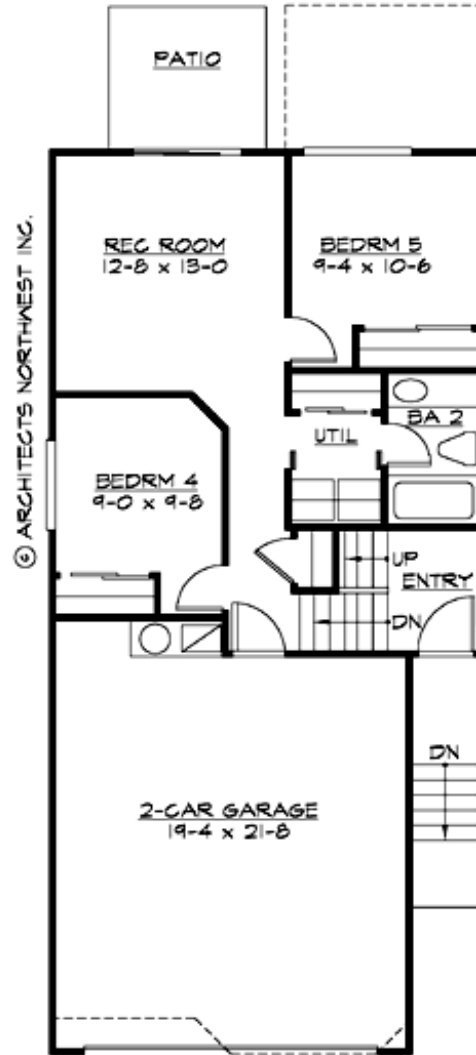

WEBBER - PLAN S1705A2F-0

UPPER FLOOR

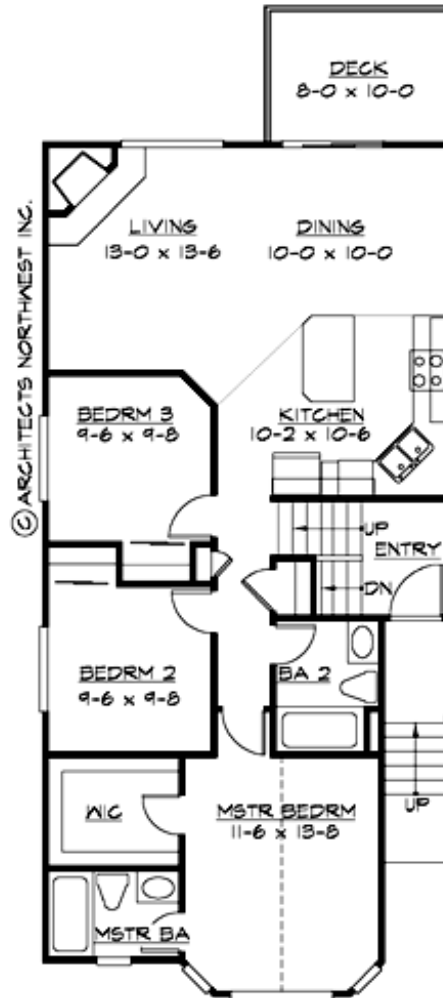



WEBBER - PLAN S1705A2F-0

PLAN DETAILS

Area Summary

Total Area: 1705 sq. ft.
Main Floor: 1116 sq. ft.
3rd Floor: 589 sq. ft.
Garage Floor: 459 sq. ft.

General Information

Stories: 2
Width: 24'-0"
Depth: 58'-0"
Height: 23'-6"

Architectural Style

Contemporary
Northwest
Shotgun

Number of Rooms

Bedrooms: 5
Full Baths: 3

Garage

Garage Size: 2
Garage Door Location: Front

Roof Pitches

Primary: 6:12

Wall Heights

Main: 8'-0"
Upper: 0'-0"
3rd Floor: 0'-0"
Lower: 8'-0"

Foundation Type

Slab On Grade

Roof Framing

Trusses

Floor Load

Live (lbs): 40 PSF
Dead (lbs): 10 PSF

Roof Load

Live (lbs): 25 PSF
Dead (lbs): 15 PSF
Wind: 85 MPH

Design Features

- Affordable Plan
- Bonus Space @ Lower Floor
- Laundry Room @ Lower Floor
- Living & Family Room
- Master Bedroom @ Main Floor Front
- Narrow Lot