



ELLENSBURG - PLAN R2195A3FA-0DB

Total Area: 3634 sq. ft.
Garage Area: 1023 sq. ft.
Garage Area: 1023 sq. ft.
Garage Size: 3
Stories: 2
Bedrooms: 2
Full Baths: 3
Half Baths: 1
Width: 110'-0"
Depth: 61'-0"
Height: 21'-6"
Foundation: Daylight Basement





This floor plan shows a 3,500 sq. ft. house with a 3-car garage. The layout includes a large Great Room (17-0 x 21-4) with a fireplace and access to a deck. A central Dining area (12-0 x 13-0) is adjacent to a Kitchen (12-0 x 13-6) and a breakfast room (8-6 x 10-2). The house features a Foyer, a Covered Entry, and a Den (8-4 x 10-0). The sleeping quarters consist of a Master Bedroom (14-6 x 13-0) with a private bathroom and closet, and a second Bedroom (11-0 x 10-0) with its own bathroom and closet. A central hallway connects the bedrooms to the living areas. The 3-Car Garage (33-0 x 23-4) is attached to the side of the house. The plan also shows a utility room, a second bathroom, and several closets.

Ellensburg - Plan R2195A3FA-0DB ::: Page 2 of 4

ELLENSBURG - PLAN R2195A3FA-0DB

LOWER FLOOR

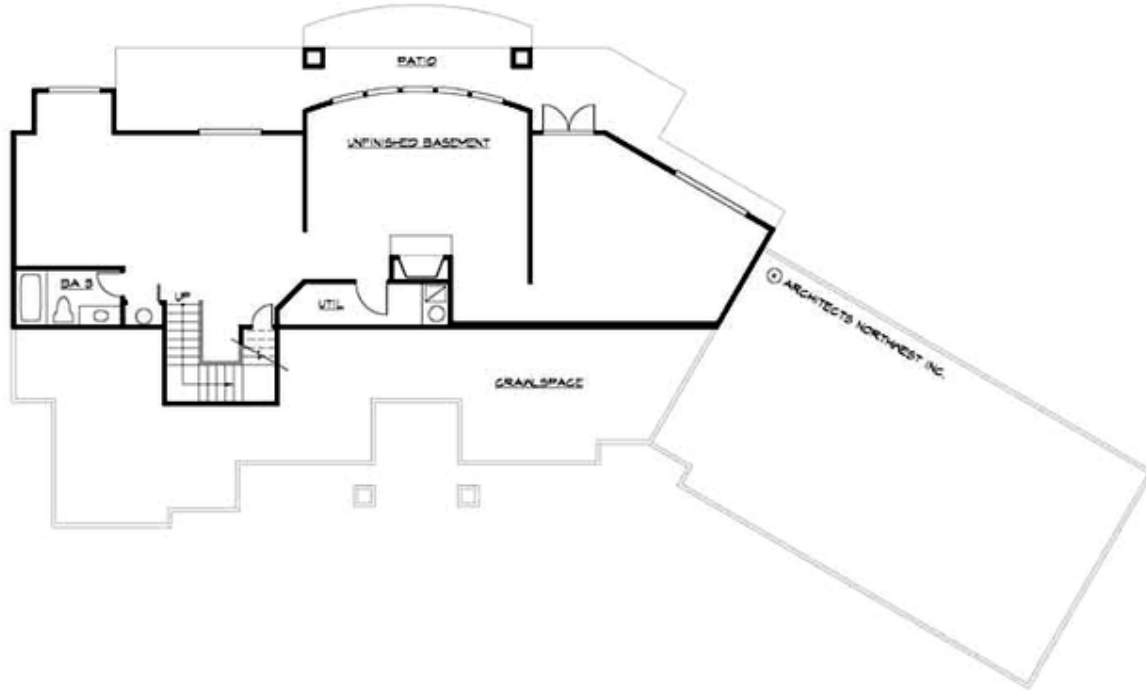



ELLENSBURG - PLAN R2195A3FA-0DB

PLAN DETAILS

Area Summary

Total Area: 3634 sq. ft.
Main Floor: 2195 sq. ft.
Lower Floor: 1439 sq. ft.
Garage Floor: 1023 sq. ft.

General Information

Stories: 2
Width: 110'-0"
Depth: 61'-0"
Height: 21'-6"

Architectural Style

Craftsman
Lodge
Northwest

Number of Rooms

Bedrooms: 2
Full Baths: 3
Half Baths: 1

Garage

Garage Size: 3
Garage Door Location: Front
Garage Type: Angled

Roof Pitches

Primary: 9:12
Secondary: 12:12

Wall Heights

Main: 9'-0"
Upper: 0'-0"
3rd Floor: 0'-0"
Lower: 10'-0"

Foundation Type

Daylight Basement

Roof Framing

Trusses

Floor Load

Live (lbs): 40 PSF
Dead (lbs): 10 PSF

Roof Load

Live (lbs): 25 PSF
Dead (lbs): 15 PSF
Wind: 85 MPH

Design Features

- Best Selling Plan
- Bonus Space @ Lower Floor
- Den/Office
- Great Room
- Laundry Room @ Main Floor
- Master Bedroom @ Main Floor Rear
- Rear Porch
- Wide Lot